

EXTEND FLASHING OVER JOINT BETWEEN BLOCKING AND WALL 1" MIN.

FLEXCLAD METAL FASTENED 4" O.C. STAGGERED USING GALVANIZED ANNULAR RING NAILS OR OTHER APPROVED FASTENER

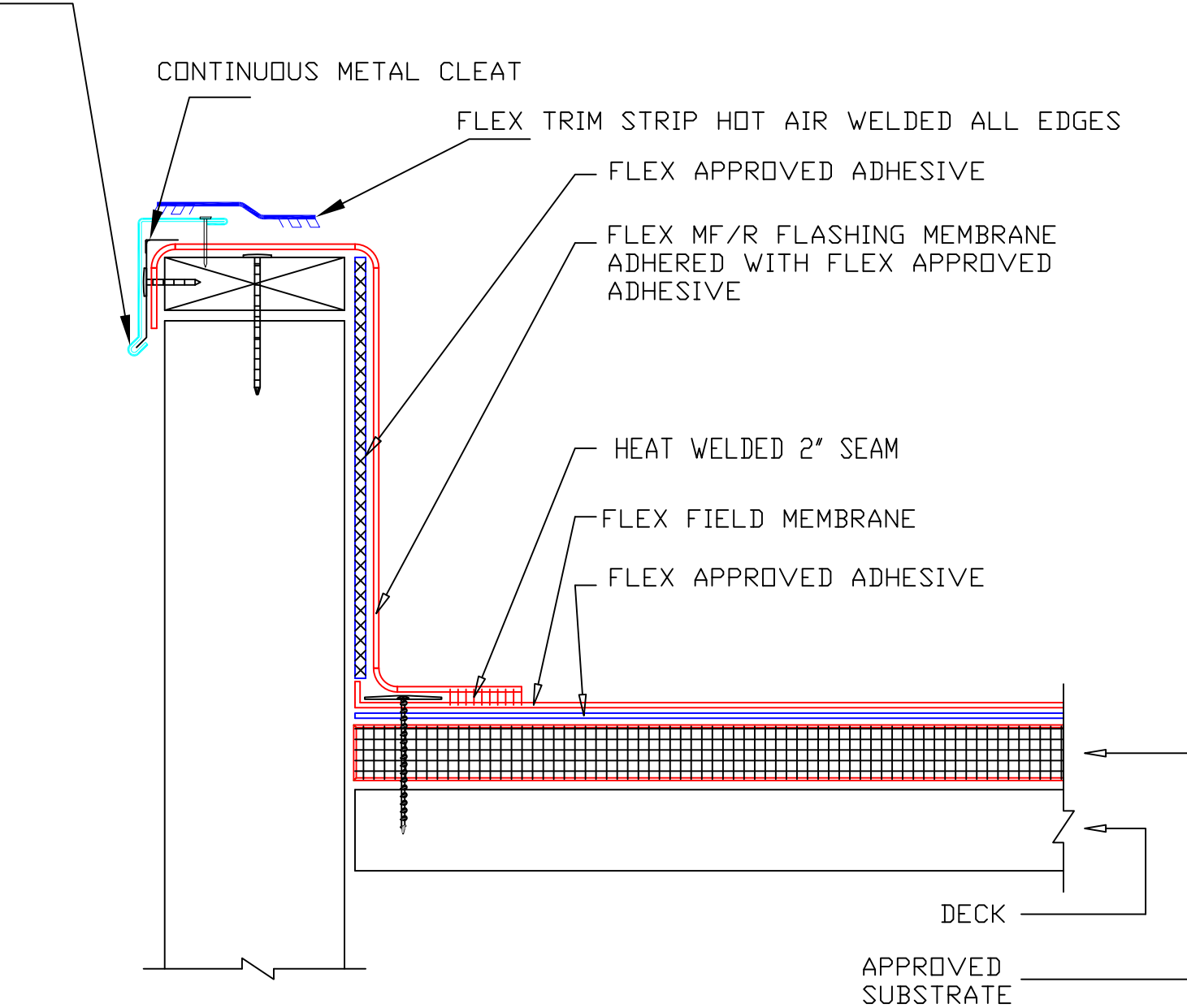

- 1) ALL FLASHINGS MUST BE A MIN. HEIGHT OF 8" ABOVE THE FIELD MEMBRANE.
- 2) ALL FLASHING MEMBRANE THAT IS INSTALLED HIGHER THAN 18" VERTICAL MUST BE ADHERED TO SUBSTRATE.
- 3) IF FLASHING HEIGHT IS HIGHER THAN 48" PLEASE REFER TO FLEX DETAIL 2.40.
- 4) FLEX TPO ONLY: FLEX TPO CUT EDGE SEALANT IS REQUIRED ON ALL NON FACTORY CUT EDGES OF FLEX TPO

TITLE		PARAPET WALL WITH FLEX CLAD METAL FASCIA
NAME		DETAIL 2.31
DRAWN BY:	MG	DATE: 2/16/2023
APPLICABLE TO ALL FLEX		
ROOFING SYSTEMS		
FLEX MEMBRANE INTERNATIONAL	5103A POTTSVILLE PIKE READING, PA 19605 800-969-0108 FLEXROOFINGSYSTEMS.COM	